

SR-93

ROCKER SWITCH SR-93 SERIES



SR-93R

ROCKER SWITCH

ROTARY SWITCH

PUSH SWITCH

MICRO SWITCH

SLIDE SWITCH

INDICATOR LAMP

AC SOCKET

KEYBOARD SWITCH

TIMER SWITCH

POWER TOOL SWITCH

SPECIFICATIONS

	6(2)A	250VAC	T125/55	5E4
	10(3)A	250VAC	T125/55	
<p>RECOGNIZED COMPONENT</p> <p>Intertek 4006154 5022251</p> <p>Conforms to UL STD.61058-1. Certified To CSA STD.C22.2 No. 61058-1.</p>	6(2)A	125/250VAC	T125/55	5E4
	10(3)A	125/250VAC	T125/55	
	16A GP	125VAC	T125/55	

FEATURES

- Usage: Coffee machine
用途：咖啡機
- Single Pole
單極
- Round Button/With Indicator lamp option
圓形按鈕//指示燈功能
- Temperature Rating: -10°C~125°C
額定溫度：-10°C~125°C
- Flammability Rating: UL94V-2 / Optional UL94V-0
易燃性等級：UL94V-2 / 可選 UL94V-0

ORDER INFORMATION

A	L	Q	2	BK	BK	4	0	0	0	0	
FUNCTION	CURRENT	TERMINAL	BASE TYPE	BASE COLOR	BUTTON COLOR	BUTTON TYPE	PRINTING	COLOR OF PRINTING	SMALL LEN COLOR	LAMP VOLTAGE	INTERNAL USE ONLY
A ON-OFF	L 10(3)A 250VAC	Q	2	BK Black	BK Black	4	0 NONE	0 None	00 None	0 None	
D (ON)-OFF	6(2)A 250VAC 5E4	A			WT White	5	1	1 White	RE Red	1 12V	
N ON-OFF w/lamp (Unswitched neutral)	16A GP 125VAC	B			GE Grey	6	2	2 Black	GR Green	2 24V	
R (ON)-OFF w/Lamp		C			RE Red	8	3	3 Red	BL Blue	3 110V	
					GR Green	9	4	4 Blue	OR Amber	4 220V	
					BL Blue	R	5	5 Yellow			
					OR Amber	A					
					YE Yellow						

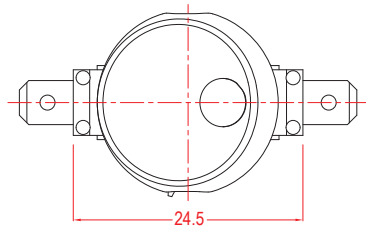

SUGGESTED PANEL HOLE SIZE

