

SL-306

SLIDE SWITCH SL-306 SERIES



SL-306-P



SL-306-S1

SPECIFICATIONS

	16(3)A	250VAC	T85	
 RECOGNIZED COMPONENT Conforms to UL STD.61058-1. Certified To CSA STD. C22.2 No. 61058-1.	16(3)A	125/250VAC	T85	6E3/1E4

FEATURES

- Usage: Haircare product
用途：美髮產品
- 2 terminals output, safe breaking design
2端子輸出·安全斷路設計
- Different Knob option
不同的旋鈕選項
- 3 positions
3個檔位
- Temperature Rating: -10°C~125°C
額定溫度：-10°C~125°C
- Flammability Rating: UL94V-2 / Optional UL94V-0
可燃性等級：UL94V-2 / 可選 UL94V-0

ORDER INFORMATION

001 L 1 S1

CIRCUIT: 001 MORE

CURRENT: L16(3)A 250VAC

Knob Type 1: 6.2, 3.5

Knob Type 2: 4.6, 2.8

Terminal Type S1: 1.3, 2.5, 3.7, 0.50, 0.30

INTERNAL USE ONLY

A VIEW: 1.5, 0.50, 0.30

B VIEW: 1.5

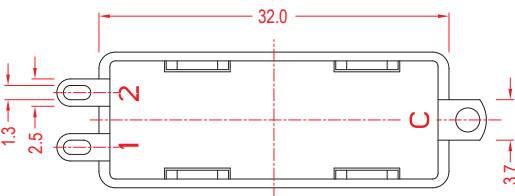
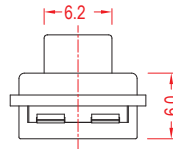
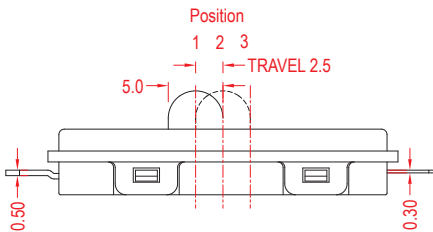
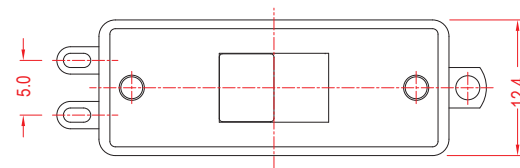

CIRCUIT OPTIONS

POSITION	*CIRCUIT001		*CIRCUIT002	
	ELECTRIC CIRCUIT C-1	C-2	ELECTRIC CIRCUIT C-1	C-2
1				
2	•		•	
3	•	•	•	•

*with production mould
For more circuit options, please call factory

CIRCUIT DIAGRAM

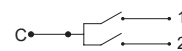

ROCKER SWITCH

ROTARY SWITCH

PUSH SWITCH

MICRO SWITCH

INDICATOR LAMP

AC SOCKET

KEYBOARD SWITCH

TIMER SWITCH

POWER TOOL SWITCH