

PM01

PUSH SWITCH PM01 SERIES



PM01A

PM01A

PM01D

PM01E

PM01F

SPECIFICATIONS

RECOGNIZED COMPONENT



Conforms to UL STD. 61058-1.
Certified To CSA STD. C22.2
No. 61058-1.

0.1A 24VDC 25T85μ 1E5

3A 24VDC 25T85μ 1E5

1A 250VAC 25T85μ 1E5

2A 125VAC 25T85μ 1E5

3A 250VAC 25T85μ 1E5

5A 125VAC 25T85μ 1E5

8A 30VDC 25T85μ 2E4

FEATURES

- Usage: Kitchen appliance, Medical device, Industrial machine
用途：廚房家電、醫療器械、工業機械
- Signal and Power switch
訊號及主開關應用
- Metal housing with IP67 waterproof level and Explosion-proof
IP67防水等級的金屬外殼·防爆設計
- With Indicator lamp design
帶指示燈設計
- Temperature Rating: -25°C~85°C
額定溫度：-25°C~85°C
- Flammability Rating: UL94V-2 / Optional UL94V-0
可燃性等級：UL94V-2 / 可選 UL94V-0

ORDER INFORMATION

A	1	M	1	U	1	0	0	H	INTERNAL USE ONLY
FUNCTION	NO. OF POLES	RATING	BASE TYPE	BASE COLOR	BUTTON TYPE	LAMP COLOR	LAMP VOLTAGE	TERMINAL	
A ON-OFF w/lock	1 Single	M 3A 24VDC 0.1A 24VDC	For Ø16 Panel Hole	U NATURE	1	0 None	0 NO LAMP	H	
B ON-ON w/lock	2 Double	1A 250VAC 2A 125VAC	1 Cu-nickel plating		2	BL Blue	1 6.3VDC		
D (ON)-OFF		25T85 μ 1E5	2 Cu-chromium plating		3	GR Green	2 12VDC		
E ON-(OFF)		L 3A 250VAC 5A 125VAC	3 Stainless steel		4	RE Red	3 24VDC		
F ON-(ON)		25T85 μ 1E5	4 Cu-nickel plating		5	WT White	4 110VAC		
		8A 30VDC 25T85 μ 2E4	5 Cu-chromium plating			YE Yellow	5 220VAC		
			6 Stainless steel						
			For Ø19 Panel Hole						
			7 Cu-nickel plating						
			8 Cu-chromium plating						
			9 Stainless steel						
			For Ø22 Panel Hole						
			7 Cu-nickel plating						
			8 Cu-chromium plating						
			9 Stainless steel						

CIRCUIT DIAGRAM

	A:ON-OFF W/Lock	B:ON-ON W/Lock	D:(ON)-OFF	E:ON-(OFF)	F:ON-(ON)
Single Pole	with lamp				
	without lamp				
Double Poles	with lamp				
	without lamp				

FOR M16

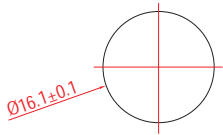

Panel hole size
Panel thickness 1-10mm
Mounting nut torque 5-14Nm

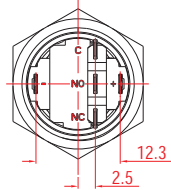
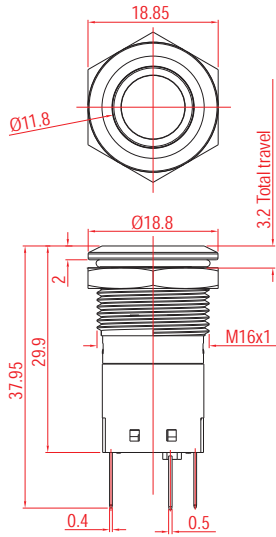
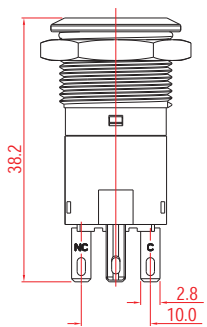

FOR M19

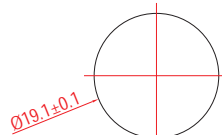

Panel hole size
Panel thickness 1-10mm
Mounting nut torque 5-14Nm

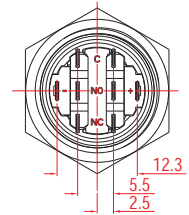
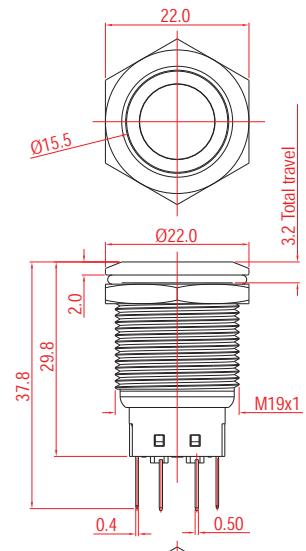
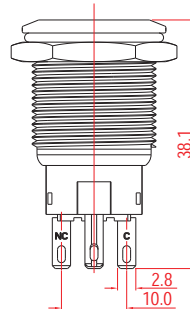

FOR M22

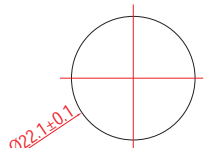

Panel hole size
Panel thickness 1-10mm
Mounting nut torque 5-14Nm

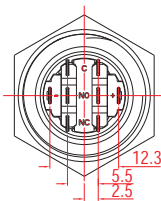
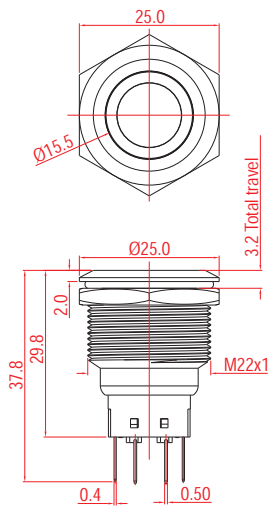
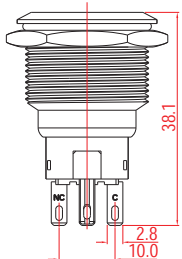

ROCKER
SWITCH

ROTARY
SWITCH

PUSH
SWITCH

MICRO
SWITCH

SLIDE
SWITCH

INDICATOR
LAMP

AC SOCKET

KEYBOARD
SWITCH

TIMER
SWITCH

POWER TOOL
SWITCH