

SL-401

SLIDE SWITCH SL-401 SERIES



SL-401-S1



SL-401-S

SPECIFICATIONS

	6(3)A	250VAC	T85	5E4
	10(3)A	250VAC	T85	
	8A	250VAC	T105	
	16A	125VAC		
<p>Recognized Component Conforms to UL STD. 61058-1. Certified To CSA STD. C22.2 No. 61058-1.</p>	8A GP	250VAC	T85	
	16A GP	125VAC	T85	
	6(3)A	250VAC	T85	5E4
	10(3)A	250VAC	T85	

FEATURES

- Usage: Haircare product
用途：美髮產品
- 4 Positions, Max control 4 circuits
4個檔位 · 最多控制4個電路
- 2 terminals output
2端子輸出
- Temperature Rating: -10°C~105°C
額定溫度：-10°C~105°C
- Flammability Rating: UL94V-2 / Optional UL94V-0
可燃性等級：UL94V-2 / 可選 UL94V-0

ORDER INFORMATION

001	L	1	S1	INTERNAL USE ONLY
CIRCUIT	CURRENT	KNOB TYPE	TERMINAL TYPE	
001	L10(3)A 250VAC	1	S	
002	6(3)A 250VAC 5E4			
004	16A GP 125VAC			
006				
007				
008				
010				
MORE				

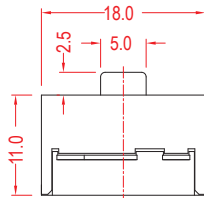
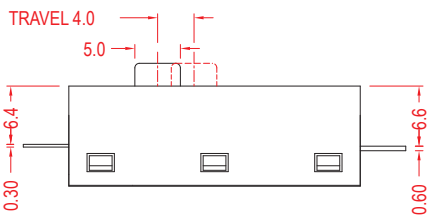
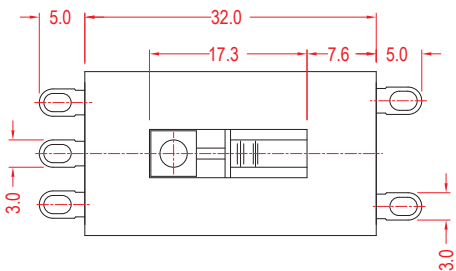

CIRCUIT OPTIONS

*CIRCUIT001	*CIRCUIT002	*CIRCUIT004	*CIRCUIT006																																																
<table border="1"> <tr><th>POSITION</th><th>ELECTRIC CIRCUIT</th></tr> <tr><td></td><td>C1-1 C1-2 C2-3</td></tr> <tr><td>1</td><td>● ● ●</td></tr> <tr><td>2</td><td>● ● ●</td></tr> <tr><td>3</td><td>● ● ●</td></tr> <tr><td>4</td><td>● ● ●</td></tr> </table>	POSITION	ELECTRIC CIRCUIT		C1-1 C1-2 C2-3	1	● ● ●	2	● ● ●	3	● ● ●	4	● ● ●	<table border="1"> <tr><th>POSITION</th><th>ELECTRIC CIRCUIT</th></tr> <tr><td></td><td>C1-1 C1-2 C2-3</td></tr> <tr><td>1</td><td>● ● ●</td></tr> <tr><td>2</td><td>● ● ●</td></tr> <tr><td>3</td><td>● ● ●</td></tr> <tr><td>4</td><td>● ● ●</td></tr> </table>	POSITION	ELECTRIC CIRCUIT		C1-1 C1-2 C2-3	1	● ● ●	2	● ● ●	3	● ● ●	4	● ● ●	<table border="1"> <tr><th>POSITION</th><th>ELECTRIC CIRCUIT</th></tr> <tr><td></td><td>C1-1 C1-2 C2-3</td></tr> <tr><td>1</td><td>● ● ●</td></tr> <tr><td>2</td><td>● ● ●</td></tr> <tr><td>3</td><td>● ● ●</td></tr> <tr><td>4</td><td>● ● ●</td></tr> </table>	POSITION	ELECTRIC CIRCUIT		C1-1 C1-2 C2-3	1	● ● ●	2	● ● ●	3	● ● ●	4	● ● ●	<table border="1"> <tr><th>POSITION</th><th>ELECTRIC CIRCUIT</th></tr> <tr><td></td><td>C1-1 C1-2 C2-3</td></tr> <tr><td>1</td><td>● ● ●</td></tr> <tr><td>2</td><td>● ● ●</td></tr> <tr><td>3</td><td>● ● ●</td></tr> <tr><td>4</td><td>● ● ●</td></tr> </table>	POSITION	ELECTRIC CIRCUIT		C1-1 C1-2 C2-3	1	● ● ●	2	● ● ●	3	● ● ●	4	● ● ●
POSITION	ELECTRIC CIRCUIT																																																		
	C1-1 C1-2 C2-3																																																		
1	● ● ●																																																		
2	● ● ●																																																		
3	● ● ●																																																		
4	● ● ●																																																		
POSITION	ELECTRIC CIRCUIT																																																		
	C1-1 C1-2 C2-3																																																		
1	● ● ●																																																		
2	● ● ●																																																		
3	● ● ●																																																		
4	● ● ●																																																		
POSITION	ELECTRIC CIRCUIT																																																		
	C1-1 C1-2 C2-3																																																		
1	● ● ●																																																		
2	● ● ●																																																		
3	● ● ●																																																		
4	● ● ●																																																		
POSITION	ELECTRIC CIRCUIT																																																		
	C1-1 C1-2 C2-3																																																		
1	● ● ●																																																		
2	● ● ●																																																		
3	● ● ●																																																		
4	● ● ●																																																		
<table border="1"> <tr><th>POSITION</th><th>ELECTRIC CIRCUIT</th></tr> <tr><td></td><td>C1-1 C1-2 C2-3</td></tr> <tr><td>1</td><td>● ● ●</td></tr> <tr><td>2</td><td>● ● ●</td></tr> <tr><td>3</td><td>● ● ●</td></tr> <tr><td>4</td><td>● ● ●</td></tr> </table>	POSITION	ELECTRIC CIRCUIT		C1-1 C1-2 C2-3	1	● ● ●	2	● ● ●	3	● ● ●	4	● ● ●	<table border="1"> <tr><th>POSITION</th><th>ELECTRIC CIRCUIT</th></tr> <tr><td></td><td>C1-1 C1-2 C2-3</td></tr> <tr><td>1</td><td>● ● ●</td></tr> <tr><td>2</td><td>● ● ●</td></tr> <tr><td>3</td><td>● ● ●</td></tr> <tr><td>4</td><td>● ● ●</td></tr> </table>	POSITION	ELECTRIC CIRCUIT		C1-1 C1-2 C2-3	1	● ● ●	2	● ● ●	3	● ● ●	4	● ● ●	<table border="1"> <tr><th>POSITION</th><th>ELECTRIC CIRCUIT</th></tr> <tr><td></td><td>C1-1 C1-2 C2-3</td></tr> <tr><td>1</td><td>● ● ●</td></tr> <tr><td>2</td><td>● ● ●</td></tr> <tr><td>3</td><td>● ● ●</td></tr> <tr><td>4</td><td>● ● ●</td></tr> </table>	POSITION	ELECTRIC CIRCUIT		C1-1 C1-2 C2-3	1	● ● ●	2	● ● ●	3	● ● ●	4	● ● ●	<table border="1"> <tr><th>POSITION</th><th>ELECTRIC CIRCUIT</th></tr> <tr><td></td><td>C1-1 C1-2 C2-3</td></tr> <tr><td>1</td><td>● ● ●</td></tr> <tr><td>2</td><td>● ● ●</td></tr> <tr><td>3</td><td>● ● ●</td></tr> <tr><td>4</td><td>● ● ●</td></tr> </table>	POSITION	ELECTRIC CIRCUIT		C1-1 C1-2 C2-3	1	● ● ●	2	● ● ●	3	● ● ●	4	● ● ●
POSITION	ELECTRIC CIRCUIT																																																		
	C1-1 C1-2 C2-3																																																		
1	● ● ●																																																		
2	● ● ●																																																		
3	● ● ●																																																		
4	● ● ●																																																		
POSITION	ELECTRIC CIRCUIT																																																		
	C1-1 C1-2 C2-3																																																		
1	● ● ●																																																		
2	● ● ●																																																		
3	● ● ●																																																		
4	● ● ●																																																		
POSITION	ELECTRIC CIRCUIT																																																		
	C1-1 C1-2 C2-3																																																		
1	● ● ●																																																		
2	● ● ●																																																		
3	● ● ●																																																		
4	● ● ●																																																		
POSITION	ELECTRIC CIRCUIT																																																		
	C1-1 C1-2 C2-3																																																		
1	● ● ●																																																		
2	● ● ●																																																		
3	● ● ●																																																		
4	● ● ●																																																		
<table border="1"> <tr><th>POSITION</th><th>ELECTRIC CIRCUIT</th></tr> <tr><td></td><td>C1-1 C1-2 C2-3</td></tr> <tr><td>1</td><td>● ● ●</td></tr> <tr><td>2</td><td>● ● ●</td></tr> <tr><td>3</td><td>● ● ●</td></tr> <tr><td>4</td><td>● ● ●</td></tr> </table>	POSITION	ELECTRIC CIRCUIT		C1-1 C1-2 C2-3	1	● ● ●	2	● ● ●	3	● ● ●	4	● ● ●	<table border="1"> <tr><th>POSITION</th><th>ELECTRIC CIRCUIT</th></tr> <tr><td></td><td>C1-1 C1-2 C2-3</td></tr> <tr><td>1</td><td>● ● ●</td></tr> <tr><td>2</td><td>● ● ●</td></tr> <tr><td>3</td><td>● ● ●</td></tr> <tr><td>4</td><td>● ● ●</td></tr> </table>	POSITION	ELECTRIC CIRCUIT		C1-1 C1-2 C2-3	1	● ● ●	2	● ● ●	3	● ● ●	4	● ● ●																										
POSITION	ELECTRIC CIRCUIT																																																		
	C1-1 C1-2 C2-3																																																		
1	● ● ●																																																		
2	● ● ●																																																		
3	● ● ●																																																		
4	● ● ●																																																		
POSITION	ELECTRIC CIRCUIT																																																		
	C1-1 C1-2 C2-3																																																		
1	● ● ●																																																		
2	● ● ●																																																		
3	● ● ●																																																		
4	● ● ●																																																		

*with production mould
For more circuit options, please call factory

CIRCUIT DIAGRAM

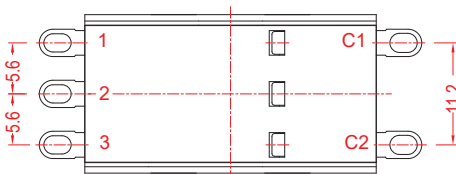
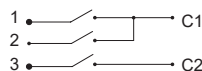

ROCKER SWITCH

ROTARY SWITCH

PUSH SWITCH

MICRO SWITCH

INDICATOR LAMP

AC SOCKET

KEYBOARD SWITCH

TIMER SWITCH

POWER TOOL SWITCH